

Series
GA
Metering Pumps

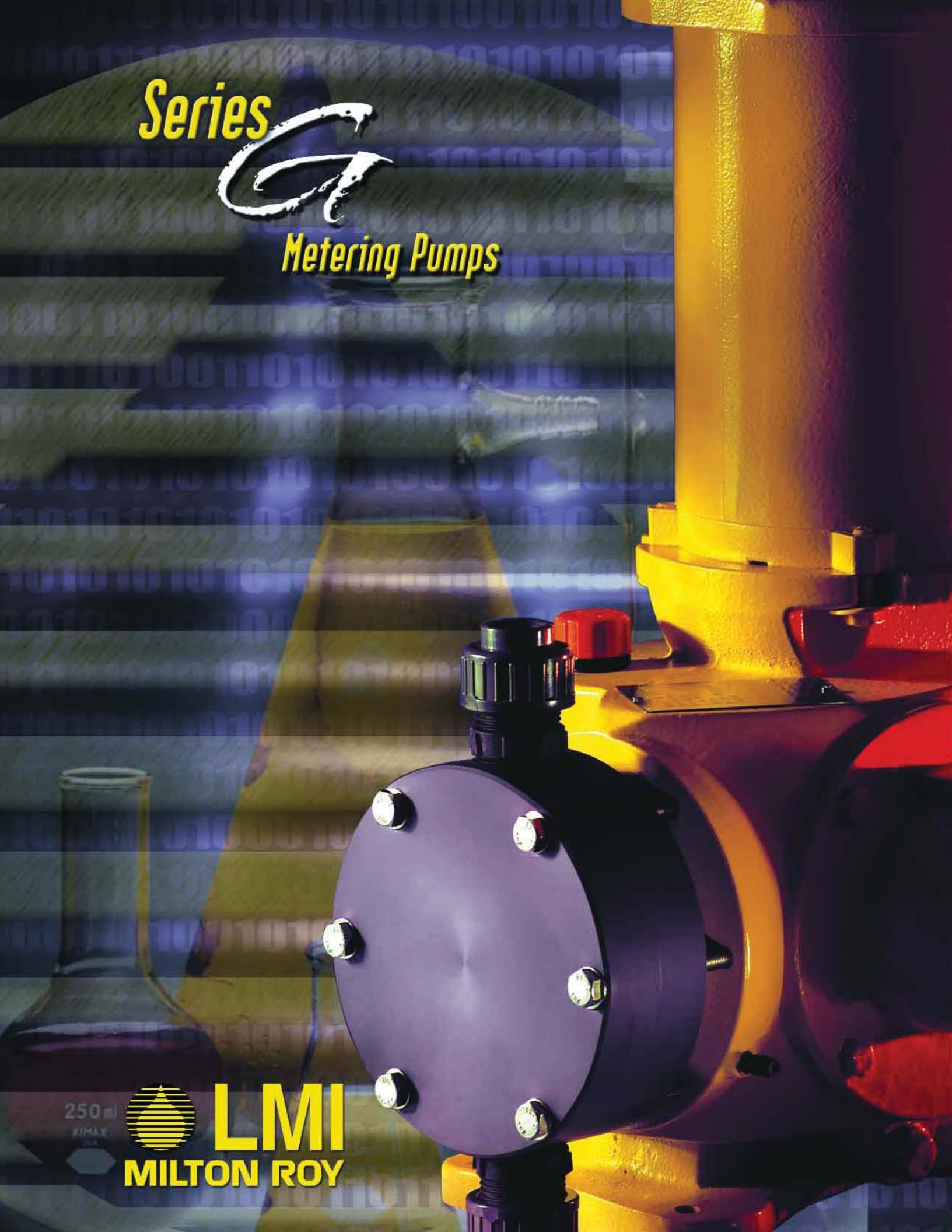

250 ml
KIMAX
USA



LMI
MILTON ROY

Dimensions

Approximate for envelope estimations. Certified prints are available.
Dimensions are showing for both D and G Frames in inches.

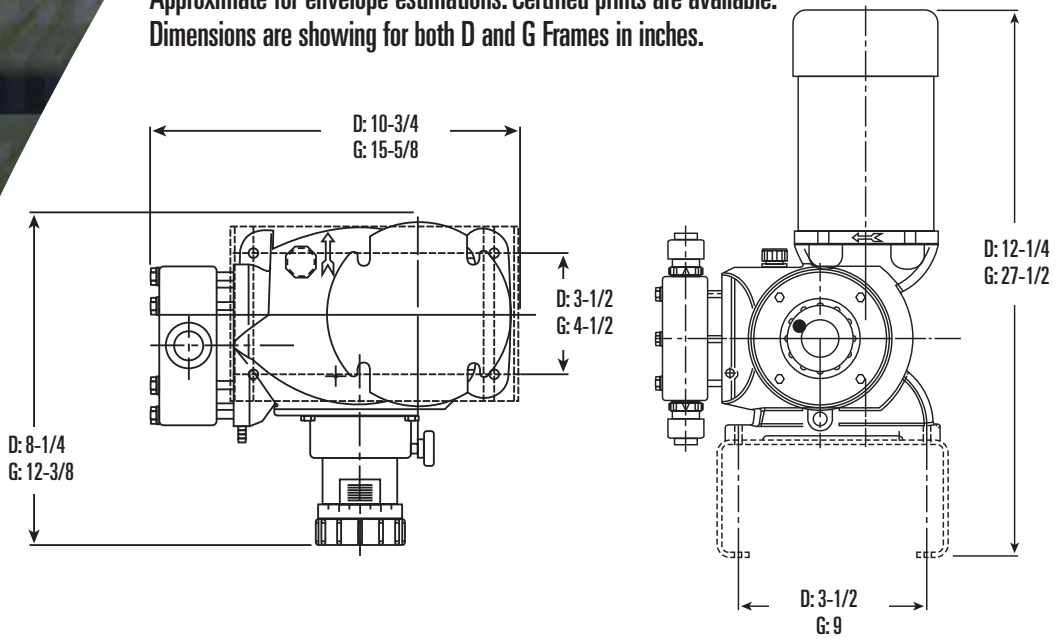

NPT Connection Sizes

Frame	Liquid End Size	Connection Port Size for the Following materials				
		Black PP, PVC, PVDF & Acrylic	Polymer	Slurry	HSO4	316 SS
D	2	1/4" Male	1/4" Male	1/4" Male	1/4" Male	1/4" Male
	4			1/2" Male		1/2" Male
	7 & 8			1/2" Female		
G	5	1" Female	1" Male	1" Female	1" Male	1" Male
	6 & 7			1" Male		1" Male

Materials of Construction

Material	Frame	Liquid End Size	Head	Check Valve	Seals	Seats	Balls	Diaphragm
White Polypropylene	G	5	White PP	PVDF	Viton	PVDF	Ceramic	PTFE
		6		PP		Polyethylene		
PVC	D	2	PVC	PVDF	Aflas	Alloy C22	Ceramic	
		4				PTFE		
		7 & 8				PVDF		
	G	5		PVC	Viton	Polyethylene		
6 & 7		Alloy C22						
PVDF	D	2	PVDF	PVDF	Aflas	Alloy C22	Ceramic	
		4				PTFE		
		7 & 8				PVDF		
	G	All		PTFE	PVDF			
Polymer Applications	D & G	All	PVC	PVC	Viton	316 SS	316 SS	
Slurry Applications	D & G	All		316 SS		316 SS		
H2SO4 Applications	D & G	All		PVDF		Aflas		CA 20
316 SS	D	2	316 SS	316 SS	316 SS	316 SS	316 SS	
		4				316 SS		
		7 & 8				PTFE		
	G	5			Viton	316 SS		
		6 & 7						PTFE

Series G

The SD & SG metering pumps offer a high level of reliability with outstanding value for applications up to 175 psi (12 Bar).

LMI has combined heavy-duty industrial drive technology with state-of-the-art design and manufacturing processes in creating the Series G metering pump.

This family of Mechanically Actuated Diaphragm metering pumps is designed for durability and cost effectiveness.

Illustrated to the right is a SD4 with a PVC liquid end, featuring NPT connections.

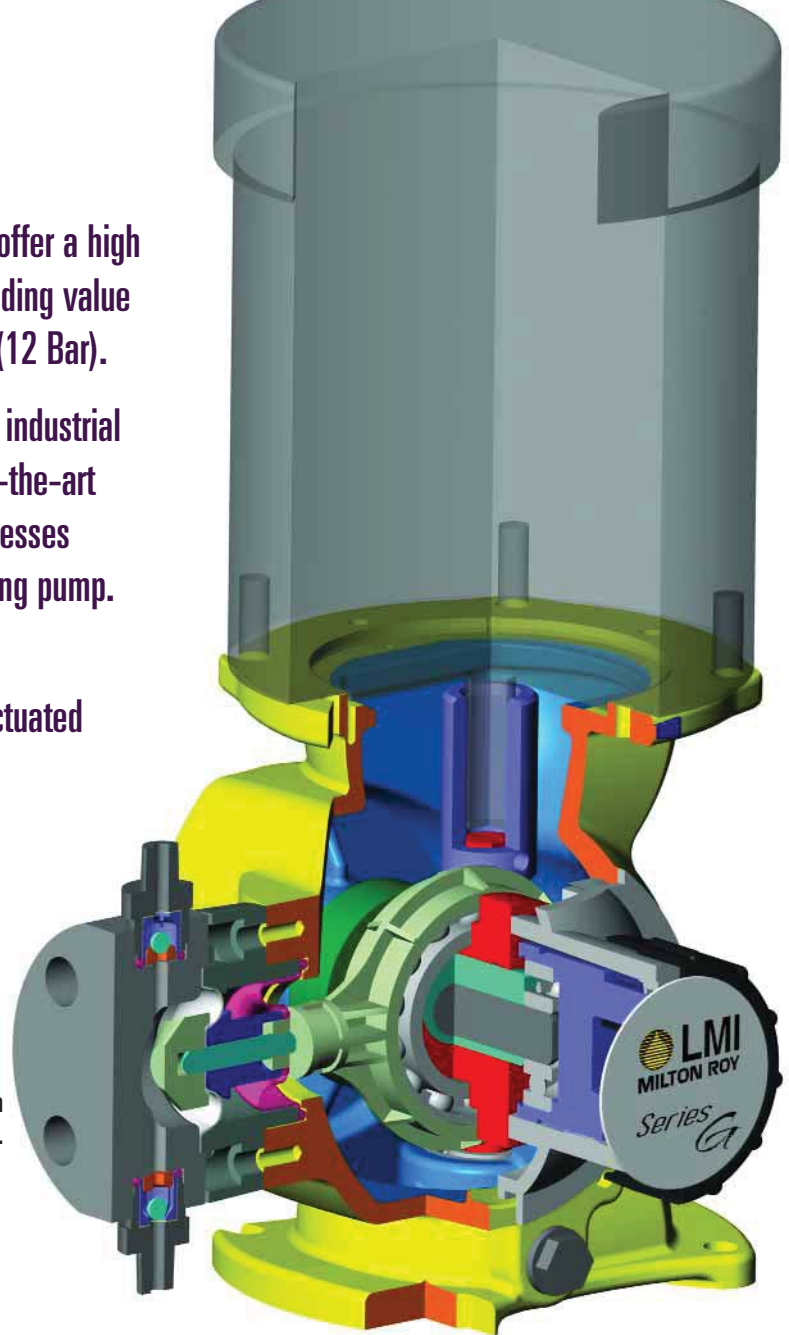

Series G Features and Specifications

- Flow Rates up to 312 GPH (1180 Liters/hr)
- Mechanically Actuated Diaphragm liquid end eliminates flow restrictions
- Durable, metallic housing designed to withstand tough environments
- High efficiency motors minimize heat buildup
- A robust, metallic, worm gear drive coupled with the industrial duty variable eccentric stroke adjustment mechanism yields a 10 to 1 turn down ratio with smooth velocity profiles as compared to the pulsating flows of solenoid pumps or lost motion designs
- Smooth running, low friction bronze gears
- The PTFE, high performance, diaphragm design increases diaphragm life by eliminating the stresses inherent in most designs
- Reliable low flow performance is a result of high performance check valves with machined seats
- All gear components operate in an oil bath for long life
- Precision stroke adjustment can be operated while the pump is running or stopped
- Steady State Accuracy - $\pm 1\%$ of full capacity over the 10 to 1 turndown ratio
- Liquid Temperature Range - 14° to 122° F (-14° to 50° C)
- Coating - 2 part epoxy
- Average Weight - Frame D: 45 lbs (20 kgs)
Frame G: 105 lbs (48 kgs)

Pump Selection by Capacity and Pressure

Pump Selection Series G			Maximum Ratings						
Frame	Liquid End	Gear Code	Capacity @ 60 Hz (1725 RPM)		Capacity @ 50 Hz (1425 RPM)		Pressure		
			GPH	Liter/Hr	GPH	Liter/Hr	PSI	Bar	
D	2	1	0.18	0.7	0.15	0.6	175	12	Ratings based on 1/4 HP (.25 kW)
		2	0.35	1.3	0.29	1.1			
		6	0.48	1.8	0.40	1.5			
		3	0.7	2.6	0.58	2.2			
	4	1	3.0	11.4	2.5	9.5	150	10	
		2	6.0	23	5.0	19			
		6	8.3	31.4	6.9	26			
		3	12	45	10	38			
	7	1	12.5	47	10.4	39	100	7	
		2	25	95	21	79			
		6	34	129	28	107			
		3	50	189	42	158			
	8	1	28	106	23	88	75	5	
		2	57	215	47	180			
		6	79	299	66	249			
		3	115	435	96	363			
G	5	1	26	98.4	22	82	150	10	
		2	53	200.6	44	167			
		6	75	283.9	62	237			
		3	106	401.2	88	334			
		8	—	—	110	416			
	6	1	37	140.0	31	117	100	7	
		2	74	280.1	62	233			
		6	104	393.6	87	328			
		3	147	556.4	122	464			
		8	—	—	154	583			
	7	1	75	283.9	62	237	50	3.5	
		2	150	567.8	125	473			
		6	213	806.2	177	672			
		3	300	1135.5	250	946			
		8	—	—	312	1181			

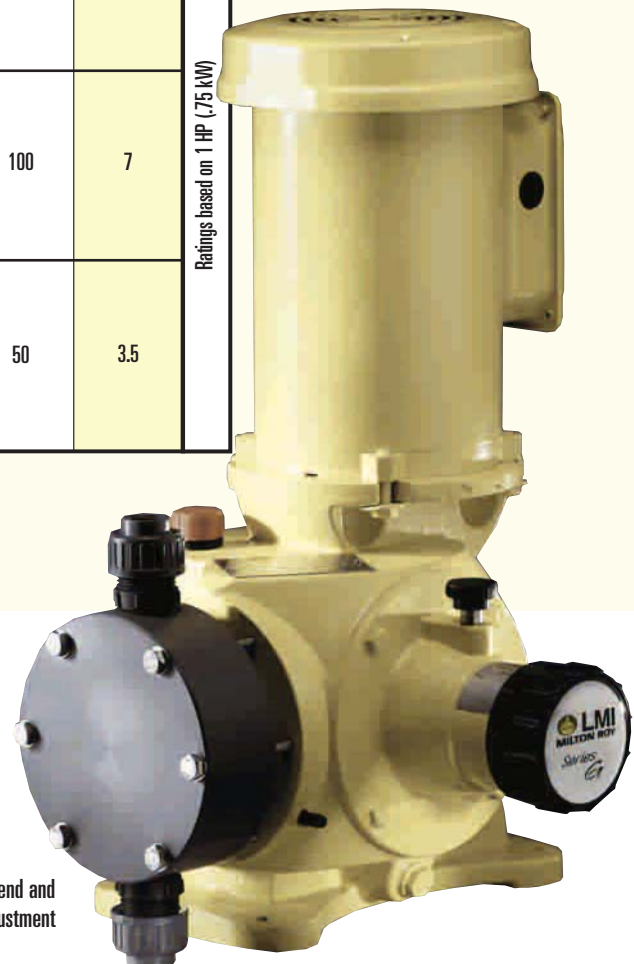

The LMI SG7 with PVC liquid end and manual micrometer stroke adjustment

Series G Product Code

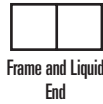

Frame and Liquid End

D Frame

SD2

SD4

SD7

SD8

G Frame

SG5

SG6

SG7

Gear Ratio Code

1 = 43 SPM

2 = 86 SPM

6 = 120 SPM

3 = 173 SPM

8 = 180 SPM @ 1425 RPM
(SG only)

Motor &/or Mount

8 = 1 ph 60 Hz 115/230 VAC 1725 RPM TE

J = 3 ph 60 Hz 230/460 VAC 1725 RPM TE

9 = 1 ph 50 Hz 115/230 VAC 1425 RPM TE

L = 3 ph 50 Hz 220/380 VAC 1425 RPM TE

X = Nema 56C Mount

Less Motor

P = DC Motor with Variable Speed Drive

Liquid End Material

1 = White Polypropylene

2 = PVDF

7 = 316 ss

8 = PVC

P = Polymer Service

L = Slurry Applications

N = H₂SO₄ Applications

Connections

P = NPT

T = Tubing

B = Bleed Valve NPT

C = Bleed Valve Tubing



The photograph to the right is a SD4 with a PVC liquid end, featuring NPT style check valves.

Series G, Dependable and Versatile



The LMI Series "G" of pumps has proven its exceptional value over years of solid performance in a wide range of applications and industries. Water treatment chemicals, process additives, acids, out-gassing fluids, slurries, and many more applications are all handled with ease by this robust metering pump design. Your local distributor can assist you in applying the SD & SG metering pumps to your process.

Accessories



Safety Valves
Protect pump and piping from overpressure.



Back Pressure Valves
Provide smooth, artificial pressure in pump discharge line for atmospheric or low pressure systems to ensure pumping accuracy.



Pulsation Dampeners
Minimize pressure and flow surges in the pump discharge. When applied to pump inlet, more favorable NPSH conditions result.

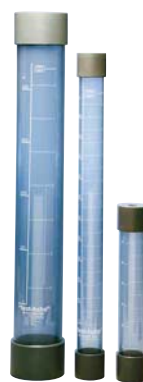

Calibration Columns
Allow periodic verification of pump performance during routine checks or after system maintenance.



201 Ivyland Road • Ivyland, PA 18974-0577 • ph: 215.293.0401 • fax: 800.327.7563
www.lmipumps.com • www.miltonroy.com • email: info@miltonroy.com